

Installation Instructions

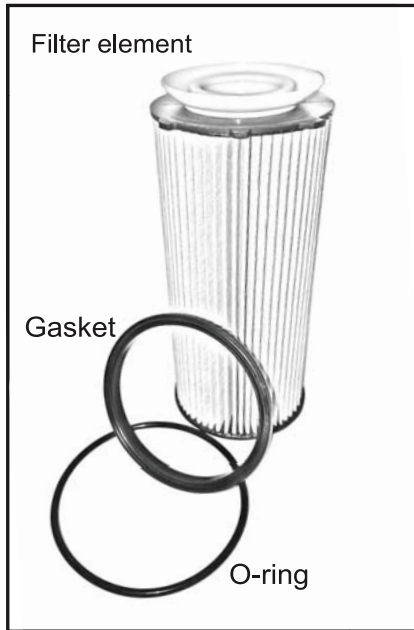

Fig.1

1. Place the gasket into the groove of the cap as shown in fig.1

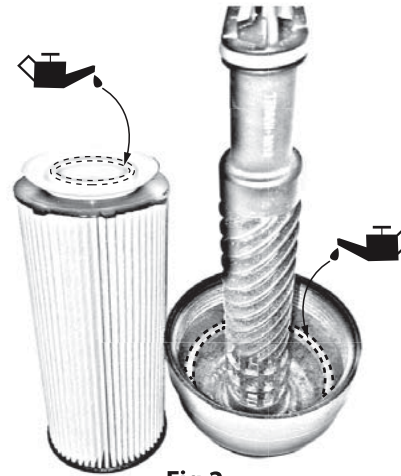

Fig.2

2. Oil the rubber membrane of the filter and the gasket inside the cap as shown in fig.2

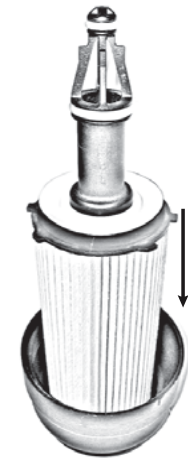

Fig.3

3. Place the filter on the cap as shown in fig.3

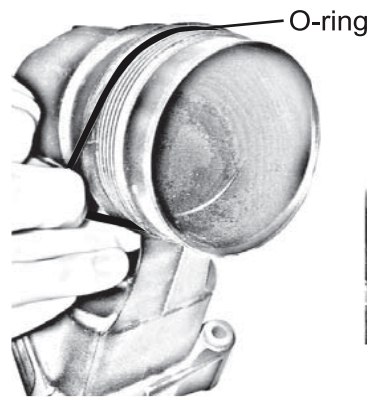
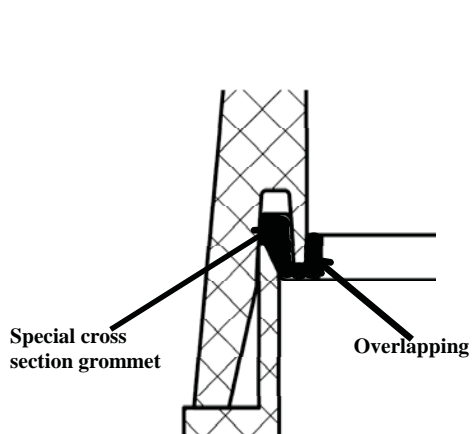

Fig.4

4. Place the O-ring on the housing as shown in fig.4

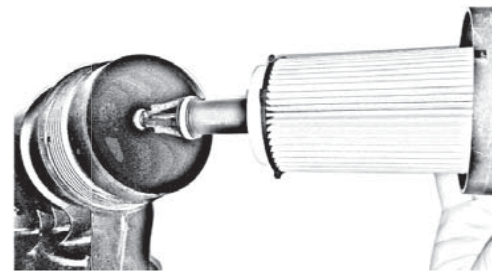

Fig.5

5. Take the already mounted filter on the cap and place it on the housing like shown in pic.5



Assembled