

(D)

**Montage-
anleitung**
**Tagfahrlicht/
Positionslicht**
Steuergerät

(GB)

**Mounting
instructions**
**Daytime running
light/Position
light Control unit**

(F)

**Instructions de
montage**
**Feu diurne/
Feu de position**
Calculateur

(S)

**Monterings-
anvisning**
**Varselljus/
Positionsljus**
Kontrollenhet

(NL)

**Montage-
handleiding**
**Dagrijlicht/
Positie licht**
Regeleenheid

(E)

**Instrucciones de
montaje**
**Luz diurna/Luz
de posición**
Unidad de control

(I)

**Istruzioni di mon-
taggio**
**Luce per di marcia
diurna/Luce di
posizione Centralina**

(FIN)

Asennusohje
Valojen
**Päiväajovalo/
Sivuvälo**
Ohjainlaite

31 schwarz black noir svart

15 87a rot red rouge röd

58 grau grey gris gra

Hella Bestellnr.
Hella Part. No.
Référence Hella
Hella best. nr.

12V: 8KA 959 186-801
24V: 8KA 959 186-811

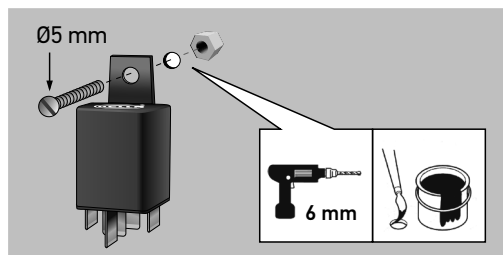

Steckerbelegung
Pin configuration
Configuration des bornes
Anslutningar

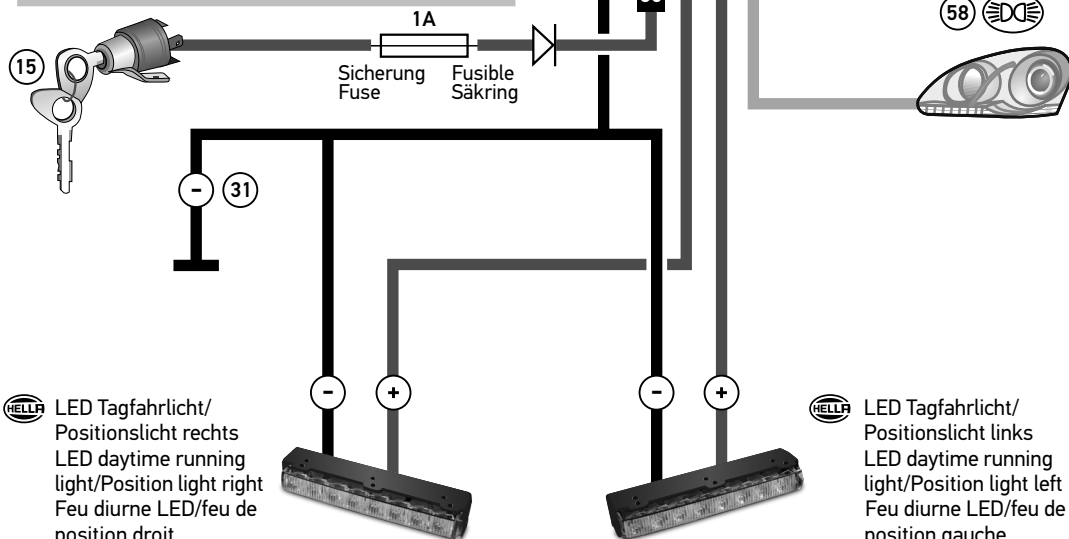
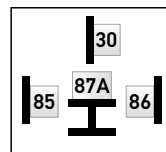

LED Tagfahrlicht/
Positionslicht links
LED daytime running
light/Position light left
Feu diurne LED/feu de
position gauche
LED-varselljus/
positionsljus vänster

31 zwart negro nero musta

15 87a rood rojo rosso punajnen

58 grijs gris grigio harmaa

Hella Betelnr.
Nº. De pedido Hella
No d'ordine Hella
Hella - nro

12V: 8KA 959 186-801
24V: 8KA 959 186-811

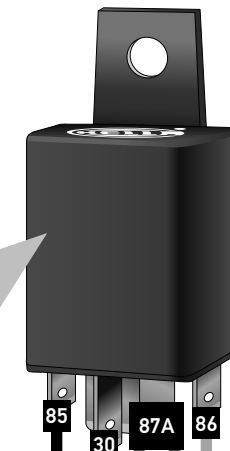
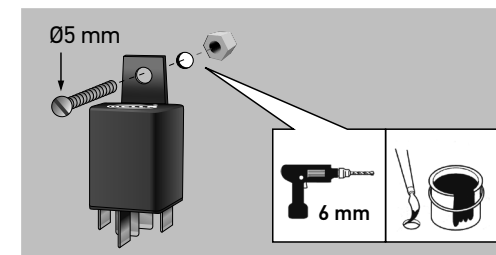

Stekkeropstelling
Disposición de clavijas
Disposizione attachi
Navoitus

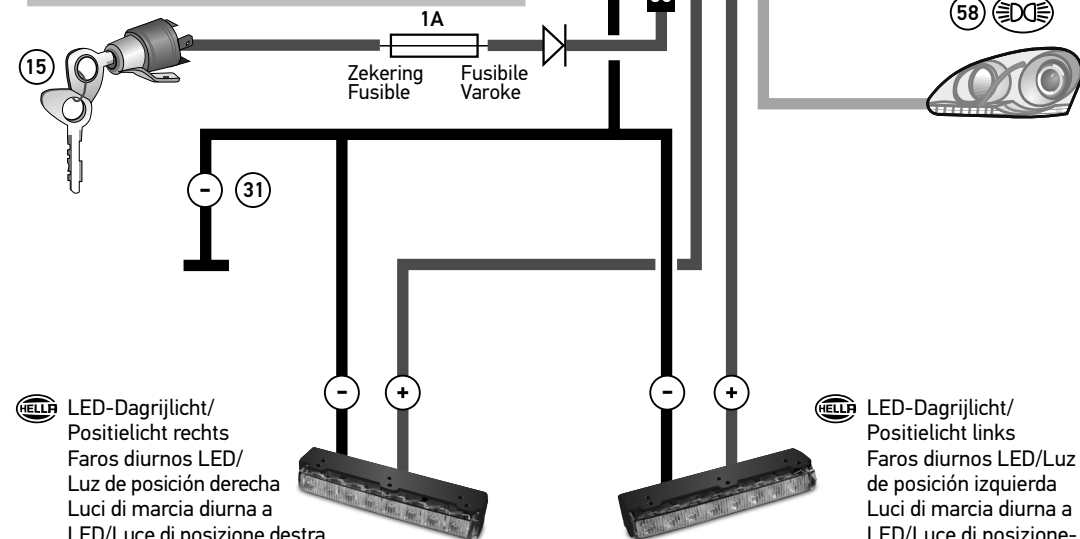
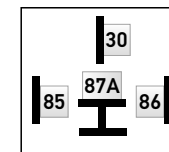

LED-Dagrijlicht/
Positielicht rechts
Faros diurnos LED/
Luz de posición derecha
Luci di marcia diurna a
LED/Luce di posizione destra
LED-Päiväajovalo/
Sivuvälo oikea

LED-Dagrijlicht/
Positielicht links
Faros diurnos LED/Luz
de posición izquierda
Luci di marcia diurna a
LED/Luce di posizione-
sinistra
LED-Päiväajovalo/
Sivuvälo vasen

